

Designs on colleges

One of Nottingham's leading architectural practices has won the Architect's design contract for a £25 million College Campus in Essex.

CBP Architects, who are based on The Ropewalk, were successful in a design-based competition for Writtle College, bringing together the main college schedule of requirements for general teaching, landscape, veterinary and art studies. The practice won the project against national competition, particularly from major London-based practices.

Writtle is a Higher Education College providing both further and higher education. A major influence on the success of the submission was the Architect's commitment to environmental and energy-saving issues, which were intrinsic from the outset incorporating the use of an existing lake and ancient moat, solar radiation gains and the aerodynamic effect between buildings. Also vital to the design was the objective of bringing the landscaping into the buildings, blurring the definition of inside and outside spaces.

This significant commission follows completion of the £9.5m refurbishment of the existing 1970's Bonington Building for Nottingham Trent University which involved incorporating five new-build sections into the existing Art and Design building, fronting Shakespeare Street.

CBP's recently established Director of Architecture, Ray Rudd, says it has been the practice's ambition to undertake larger commissions.



Views of the Bonington Building at Nottingham Trent University

The Bonington Building has been restyled to offer a multi-functional combination of education spaces from which Art and Design subjects are able to be promoted.

"With complex levels and labyrinthine circulation, the integration of the new works was a demanding but ultimately highly successful refurbishment project allowing for cohesion, unification and a flexible approach to the public and studio exhibition and teaching spaces," says Director Keith Clark, who is a past Chairman and President of the East Midland's Region of the Royal Institute of British Architects.

A light and colourful entrance invites users into the ground floor Café and Bonington shop. Studios overlook the atrium, which was constructed in an underused external courtyard.

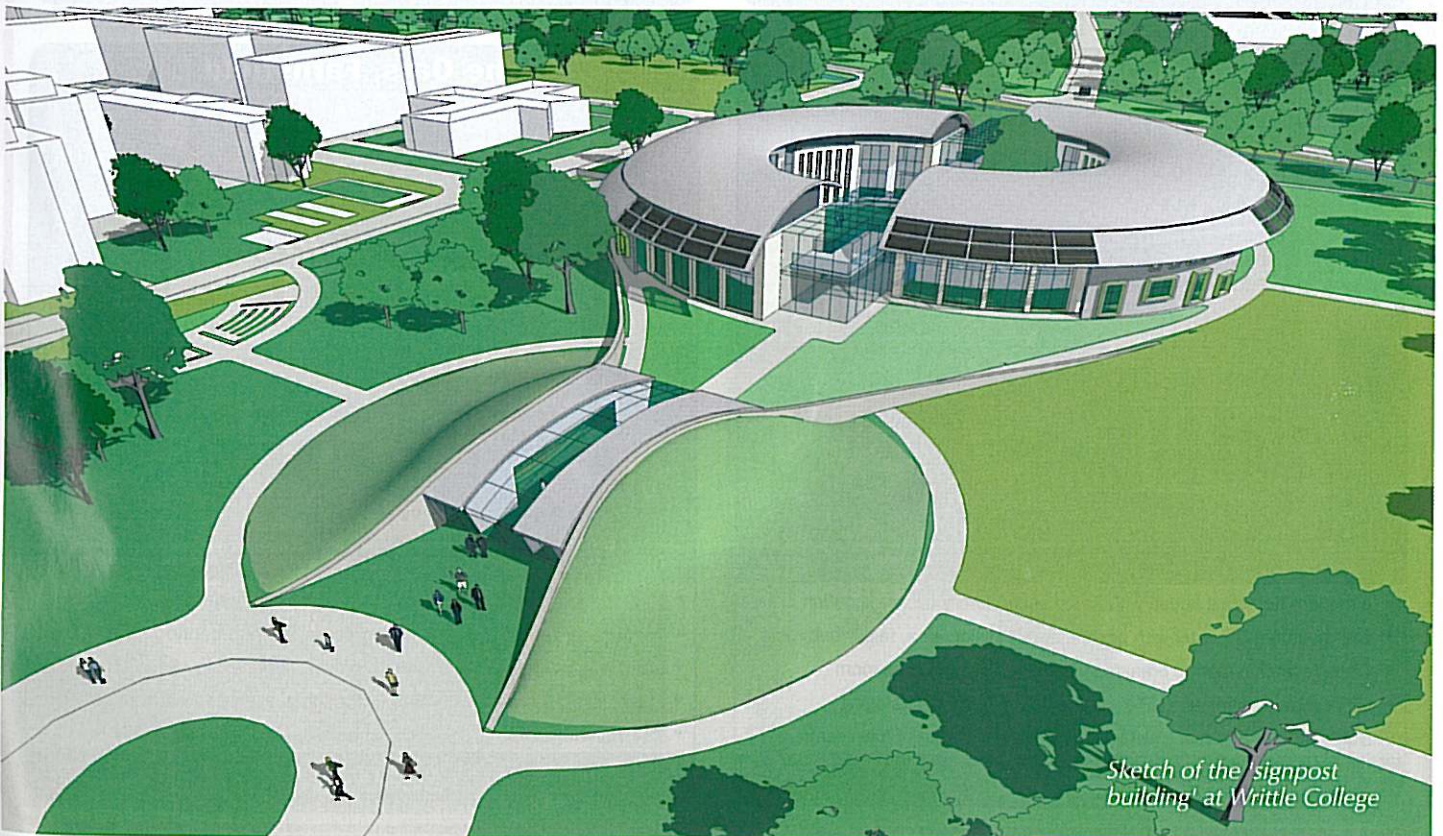

Sketch of the 'Signpost building' at Writtle College